

HSF

NOTES:
 Rated Current: 9.0AMP
 Contact Resistance: 30mΩ max
 Withstand Voltage: 1500V AC/minute
 Insulation Resistance: 1000MΩ min
 Operation Temperature: -25°C to +85°C

Contact Material: Brass
 Contact plating: Au Or Sn Over Ni
 Insulator Material: PA66 Or P46

Recommended P.C.B Layout(Top Side)
 (PCB BOARD TOLERANCE ±0.05)

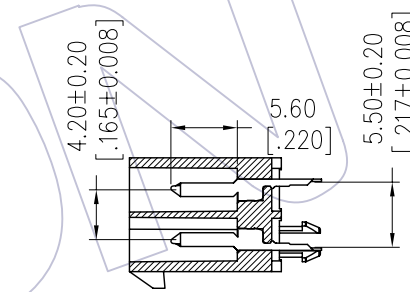
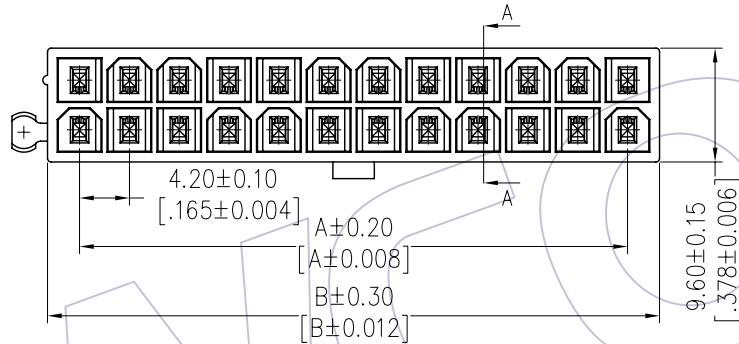
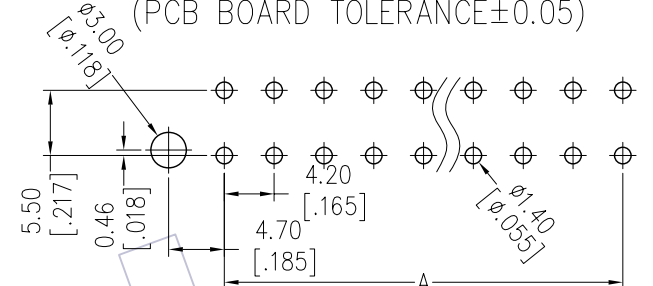

Section A-A

Specification & Ordering Information:

Ordering Information

WF4201 -2 WS XX X 0 3

No. of Row Dual Row: H=PA46, Blank=PA66
 No. of pins 01-12P: S0=Gold Flash/Tin, S3=10u"Gold/Tin, S4=15u"Gold/Tin, S5=30u"Gold/Tin, G0=Gold Flash, G3=10u"Gold, G4=15u"Gold, G5=30u"Gold, Blank=Tin
 Contact Plating: S0=Gold Flash/Tin, S3=10u"Gold/Tin, S4=15u"Gold/Tin, S5=30u"Gold/Tin, G0=Gold Flash, G3=10u"Gold, G4=15u"Gold, G5=30u"Gold, Blank=Tin
 Color: B=Black, W=White
 Packing: 0=PE Bag

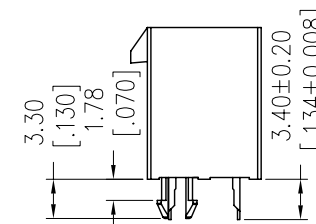
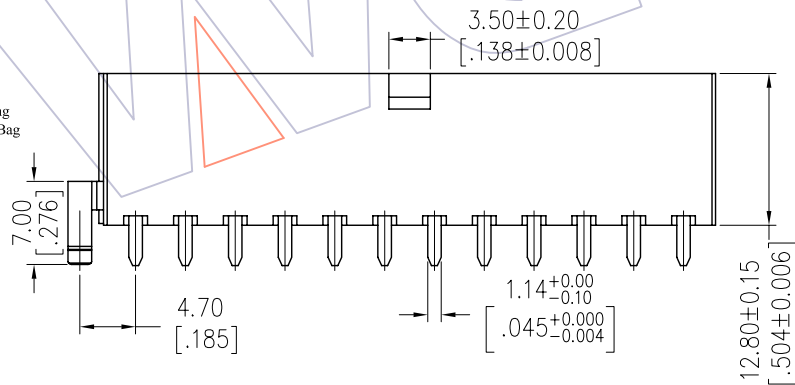

Circuit	Part No.	Dimension	
		A	B
2x01	WF4201-2WS01W03	---	5.40
2x02	WF4201-2WS02W03	4.20	9.60
2x03	WF4201-2WS03W03	8.40	13.80
2x04	WF4201-2WS04W03	12.60	18.00
2x05	WF4201-2WS05W03	16.80	22.20
2x06	WF4201-2WS06W03	21.00	26.40
2x07	WF4201-2WS07W03	25.20	30.60
2x08	WF4201-2WS08W03	29.40	34.80
2x09	WF4201-2WS09W03	33.60	39.00
2x10	WF4201-2WS10W03	37.80	43.20
2x11	WF4201-2WS11W03	42.00	47.40
2x12	WF4201-2WS12W03	46.20	51.60

REV	DATE	MODIFICATION DESCRIPTION	CHANGE	OPERATION	DRAW	DATE	SCALE	FIT	PART NO.
				X.X	JYHuang	2012/09/17	UNIT	mm	SEE TAB
				X.XX	CHECK	DATE	SIZE	A4	TITLE:
				X.XXX	APPROVE	DATE	SHEET	1/2	4.20 MINI FIT DUAL ROW 180° WITH SHORT BUMP AND SINGLE POST
				Angle			PROJ.		Customer NO.
				DIM	TOL				

WCON

Http: www.wcon.com

WCON-Dongguan Tel: +86 769 85358920 Fax: +86 769 85358915 E-mail: sales@wcon.com
 WCON-Kunshan Tel: +86 512 57468408 Fax: +86 512 57468468 E-mail: salesks@wcon.com

HSF

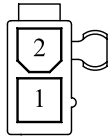

2x01P

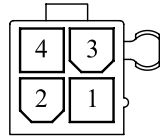

2x02P

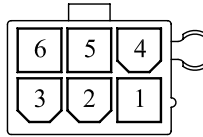

2x03P

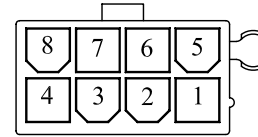

2x04P

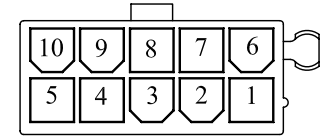

2x05P

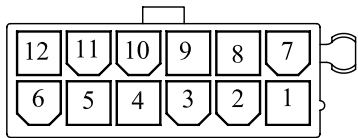

2x06P

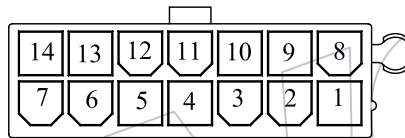

2x07P

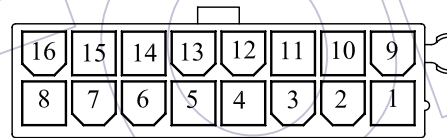

2x08P

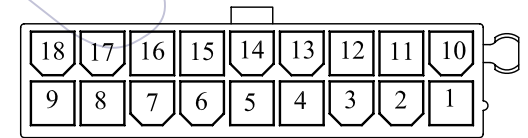

2x09P

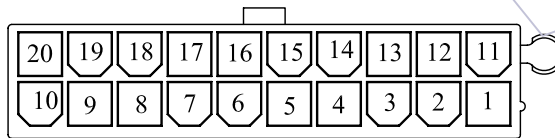

2x10P

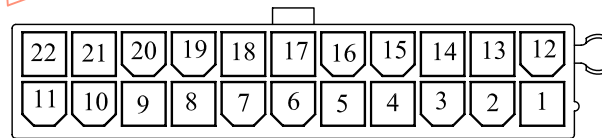

2x11P

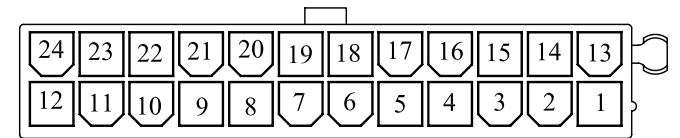

2x12P

				OPERATION	DRAW	DATE	SCALE	FIT	PART NO.	 Http: www.wcon.com
				x.X ±0.40	JYHuang	2012/09/17	UNIT	mm	WF4201-2WSXXW03	
				x.XX ±0.25	CHECK	DATE	SIZE	A4		
				x.XXX ±0.15	APPROVE	DATE	SHEET	2/2	4.20 MINI FIT DUAL ROW 180° WITH SHORT BUMP AND SINGLE POST	
AO	2012/09/17		NEW	Angle ± 3'			PROJ.	⊕	Customer NO.	WCON-Dongguan Tel: +86 769 85358920 Fax: +86 769 85358915 E-mail: sales@wcon.com
REV	DATE		MODIFICATION DESCRIPTION	DIM TOL						WCON-Kunshan Tel: +86 512 57468408 Fax: +86 512 57468468 E-mail: salesks@wcon.com